

Name of the venue	Theatre	Classroom	Reception	Banquet	U - Shape	Area m ²	Dimensions	Height	Door h/w	Floor
Puri Kencana 1	170	80	200	140	40	166.50	18.5x9	6	1.60x2.65	G
Puri Kencana 2	170	80	200	140	40	195.14	18.5x18	6	4.00x2.65	G
Puri Kencana 3	170	80	200	140	40	160.03	18.5x8.65	6	1.60x2.65	G
Puri Kencana Grand	510	240	600	420	120	521.70	18.5x28.20	6	4.00x2.65	G
Pandawa 1	60	25	75	70	20	76.70	11.80x6.50	3.15	1.70x2.50	I
Pandawa 2	30	15	50	30	10	56.64	11.80x4.80	3.15	1.70x2.50	I
Pandawa 3	120	80	150	90	40	136.29	11.80x11.55	3.15	1.70x2.50	I
Pandawa Grand	210	120	275	190	70	367.27	11.80x22.65	3.15	1.70x2.50	I
Nakula	-	-	-	-	20	46.53	9.90x4.70	3.20	1.70x2.50	I
Sadewa	-	-	-	-	20	46.53	9.90x4.70	3.20	1.70x2.50	I
Candi Bentar	-	-	200	150	-	690	-	-	-	-
Taman Gita Garden	-	-	100	80	-	400	-	-	-	-
Bukit Suite Garden	-	-	50	30	-	370	-	-	-	-
Sunset Bay View	-	-	50	40	-	380	-	-	-	-
Alun-Alun	-	-	200	150	-	640	-	-	-	-
Sunset Garden	-	-	2500	1500	-	17,400	-	-	-	-

Dimensions are approximate and in metres

G = Ground I = First floor

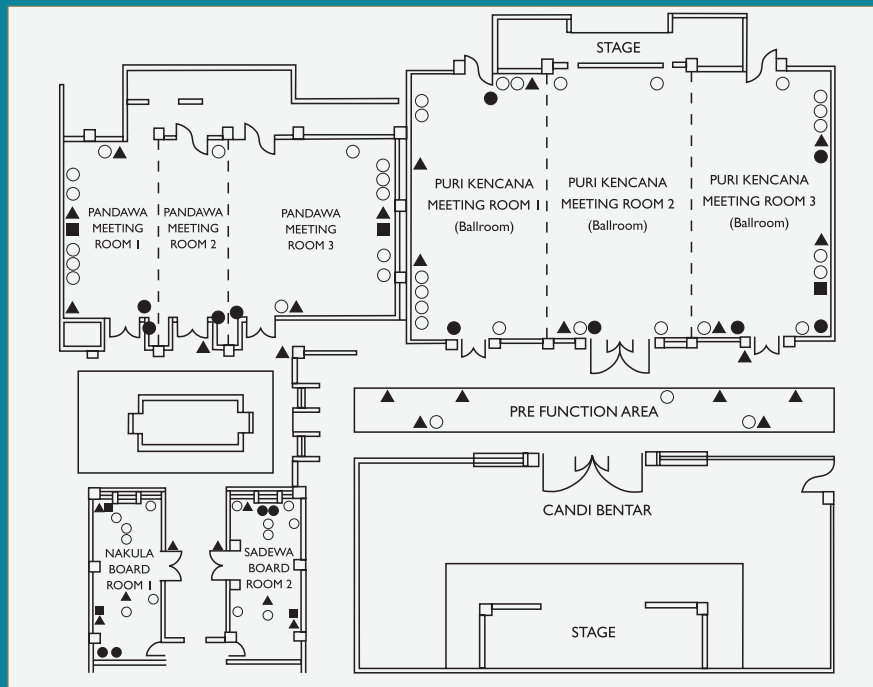

Diagrams are not to scale ○ = Power point ▲ = Telephone point/ISDN port ■ = Television socket ● = Data/ISDN port | = Removable partition

INTERCONTINENTAL BALI RESORT

Jalan Uluwatu 45 Jimbaran, Bali 80361 Indonesia

Tel +62 361 701 888 Fax: +62 361 701 777 bali@ihg.com intercontinental.com